

Shoreline Industries Inc.

INDUSTRIES

Leave your *heavy*
lifting to us.

**ShoreMaster
Whisper Winch
141 and 241**

SIDEWINDER



1025 International Drive • Fergus Falls, MN 56538 • 218-587-8700
www.shoreline-ind.com

Revised: 5-19-14

LIMITED WARRANTY

Shoreline Industries, LLC., warrants its products shall be free from defects in materials and workmanship for a period of two years from the date of purchase as shown on the customer's original invoice. Shoreline's warranty is limited to products purchased new by the original owner and is not transferable.

SHORELINE WILL AT ITS OPTION REPAIR OR REPLACE, WITHOUT CHARGE, OR ALLOW CREDIT FOR ANY SUCH GOODS FOUND ON EXAMINATION BY SHORELINE TO BE DEFECTIVE UNDER NORMAL USE AND SERVICE. THE BUYER'S REMEDIES WITH RESPECT TO DEFECTIVE GOODS SHALL BE EXCLUSIVELY LIMITED AS ABOVE AND IN NO EVENT SHALL THE SELLER BE LIABLE FOR INCIDENTAL OR CONSEQUENTIAL DAMAGES OF ANY NATURE. ALL OTHER WARRANTIES, INCLUDING BUT NOT LIMITED TO WARRANTIES OF MERCHANTABILITY AND FITNESS FOR A PARTICULAR PURPOSE, ARE EXPRESSLY DISCLAIMED.

Shoreline's warranty does not cover damage caused by circumstances outside its reasonable control, including, but not limited to, improper use, installation, overloading, accident, neglect, acts of nature, or harmful alterations or repairs made by others.

READ THROUGH THE ENTIRE MANUAL

We recommend that you read the entire manual before beginning your installation.

Follow all steps exactly.

TOOLS NEEDED

Review the **TOOLS NEEDED** list on this page. Gather all tools needed for the assembly of your unit before starting the installation steps.

- Socket Set
- Adjustable Wrench
- 1/8" Allen Wrench
- 3/8", 7/16", 1/2", 3/4" Open End Wrench
- Cordless Drill
- Socket Adapter for Drill
- Screwdrivers—Flat and Phillips
- Safety Glasses



ACCESSORIES/ OPTIONS

**BATTERY CABLE (12 VOLT ONLY)



1014376 Boatside Cable 15'

1014389 Boatside Cable 20'

1014392 Boatside Cable 25'

1014399 Boatside Cable 30'



1014965 Solar Panel 10 Watt with bracket and hardware kit (for light lift use)

1019822 Solar Panel Only

1014964 Solar Bracket



1015019 Vinyl Motor Cover Gray

1015018 Vinyl Motor Cover Burgundy

1015017 Vinyl Motor Cover Blue

1015020 Vinyl Motor Cover Green

1015022 Vinyl Motor Cover Tan

1015023 Vinyl Motor Cover White



1001764 Accessory Battery Charger 1.5 amp (for moderate lift use)



1024401 Battery Box Tray

REPLACEMENT PARTS



Remote Guide

Press the  to move the lift up.

Press the  to move the lift down.

Press the  to turn the canopy light on.

Press the  and  to lock and unlock your lift.



1020123 Replacement - Remote Key Fob

Not sold at Shoreline CR 2025 Lithium Battery (Remote requires two)

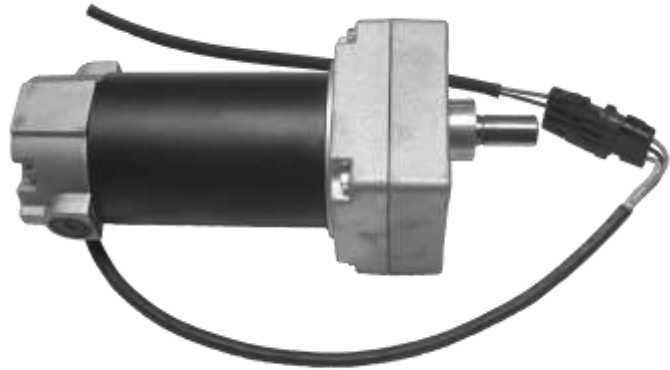

1015900 Motor 110 Volt



1015901 Motor 12 Volt



REPLACEMENT PARTS



**Same product, two views.

1014513 Bridge Rectifier
110v



1014514 Brush Cap 110v

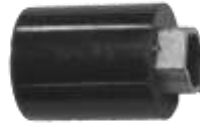

1014515 Brush Holder
110v

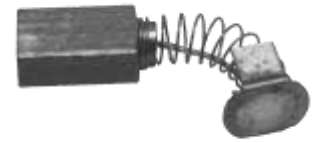

1014276 Brushes 110
Volt



1014410 Circuit Breaker
42 amp



1014516 Brush Spring 12
Volt



1014615 Remote
Antenna



**Same product, two views.

1014673 Toggle Switch



1014444 Replacement Key
Set for Key Switch
(A-126)



1014307 12 Volt Brush Kit
W/ 4 Springs



1014736 Key Switch W/
Leads 12V

PACKING LIST

INSPECT SHIPMENT

Verify that you have the proper Sidewinder™ kit for your application.

Below is a list of the available kits:

Sidewinder™ Base Kits:

Part Number	Description
1024904	Sidewinder™ 110V with Remote
1024905	Sidewinder™ 12V with Remote (Solar Panel sold separately)
1024906	Sidewinder™ 110V with Toggle Switch
1024907	Sidewinder™ 12V with Toggle Switch (Solar Panel sold separately)

(Requires mounting kit in addition to base kit; mounting kit is sold separately.)

Sidewinder™ Mounting Kits:

Part Number	Description
1024871	Sidewinder™ Mounting Kit ShoreMaster Whisper Winch

(Requires base kit in addition to mounting kit; base kit is sold separately.)

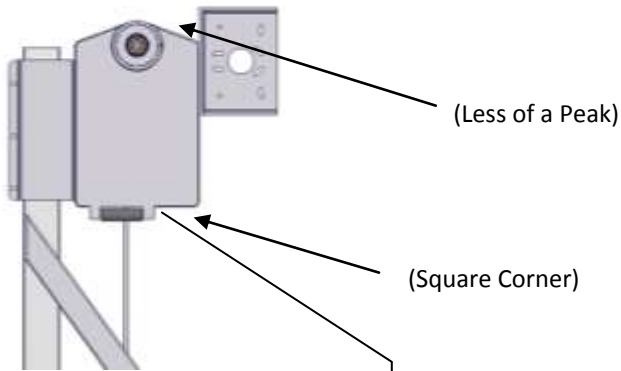

IF USING THIS STYLE WINCH,
YOU WILL REQUIRE
MOUNTING KIT #1024908

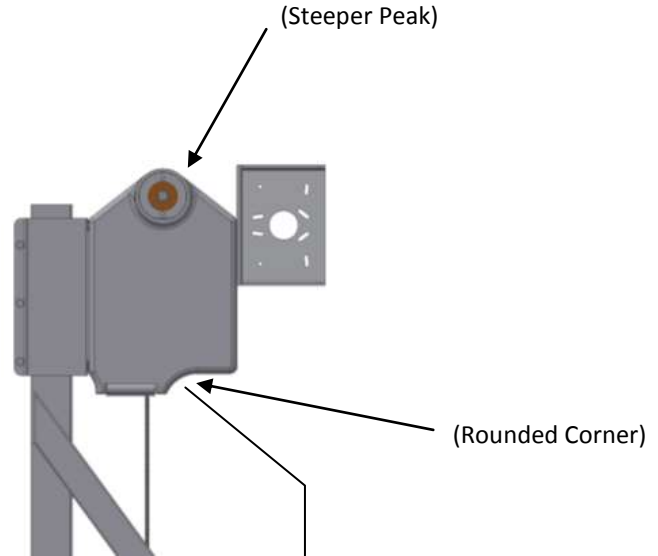

IF USING THIS STYLE WINCH,
PROCEED WITH THE FOLLOWING
DIRECTIONS



PLAN YOUR INSTALLATION

PLAN YOUR INSTALLATION

Do not proceed with the installation until you have an understanding of how you are going to install your unit.

- Verify that you have the correct base unit and mounting kit for your lift. If you do not have the correct kit, order the correct kit before proceeding with the installation.
- The Sidewinder™ attaches to the side of the winch. Inspect your winch to make sure it has holes on the side that the Sidewinder™ motor mount bracket can attach to.
- If you have a 110V Sidewinder™, make sure you have adequate power (20 amps) available and that it has a GFCI (**use only 1 GFCI**), consult an electrician if you are not sure. If you need to use an extension cord, a 12-gauge extension cord is recommended.
- If you have a 12V Sidewinder™, make sure you have a fully charged group 27-deep cycle battery.
- Lay out your Sidewinder™ base kit and Sidewinder™ mounting kit and verify that you have all parts.

INSTALLATION

STEP 1. Lower lift and make sure there is no tension on the winch cable.

STEP 2. Remove boat from boat lift.

STEP 3. Remove winch wheel kit and winch wheel. Make sure to leave brake pad on winch.

STEP 4. Attach motor mount bracket to winch. See the following pages to find instructions on how to attach the motor mount bracket to your winch.



INSTALLATION continued...

STEP 4A: Attach motor-mount bracket to whisper winch.

Parts List: Kit 1024871

Part Number	Quantity	Description
1024866	1	Wdmt Bracket - Whisper Winch Motor Mount - Sidewinder
1014421	1	Wdmt Gear 44 Tooth - Shoremaster (7/8-9 Thread)
1021706	1	Sidewinder Rear Cover - Gray Plastic
1024872	1	Bolt Bag - Sidewinder ShoreMaster Whisper Winch Mounting Kit
1014453	1	Chain Nickel Plated 62 Pin
1002565	2	Washer Flat 1/2 SS 304
1000552	2	Bolt Hex 1/2-20 x 1.0 Zinc Grade 5 (Fine Thread)
1014212	4	Bolt Hex Flange 1/4 - 20 x .75 Zinc
1014218	4	Screw Self-Drilling Hex Head 1/4 X 1" Galv Tek
1020204	1	Wdmt Gear 10 tooth w/ Nut
1014582	1	Master Link Chain # 40 Nickel Plated
1014554	1	Gear keys 3/16 x 3/16 x 1"
1014523	3	Cable Ties 8.0
1000554	1	Washer Flat .34 x 1.125 x .186 Thick Alum
1014457	1	Decal -Set of 1 Up & 1 Down Oval Blue
1002453	1	Bolt Hex 5/16-18 x 1.0 SS
1002606	1	Washer Lock 5/16 SS 304
1021705	4	Rivet-Nylon .688 Head x .813 long Black-Trim Retainer
1025111	1	MH Spacer Alum- Sidewinder / Whisper Winch



Kit: 1024871

ShoreMaster® Whisper Winch Only

INSTRUCTIONS:

ShoreMaster® Whisper Winch™: Attach Sidewinder™ motor mount bracket to

ShoreMaster® Whisper Winch™ using 1/2" x 1" fine-thread hex bolts and 1/2" washers (as shown).

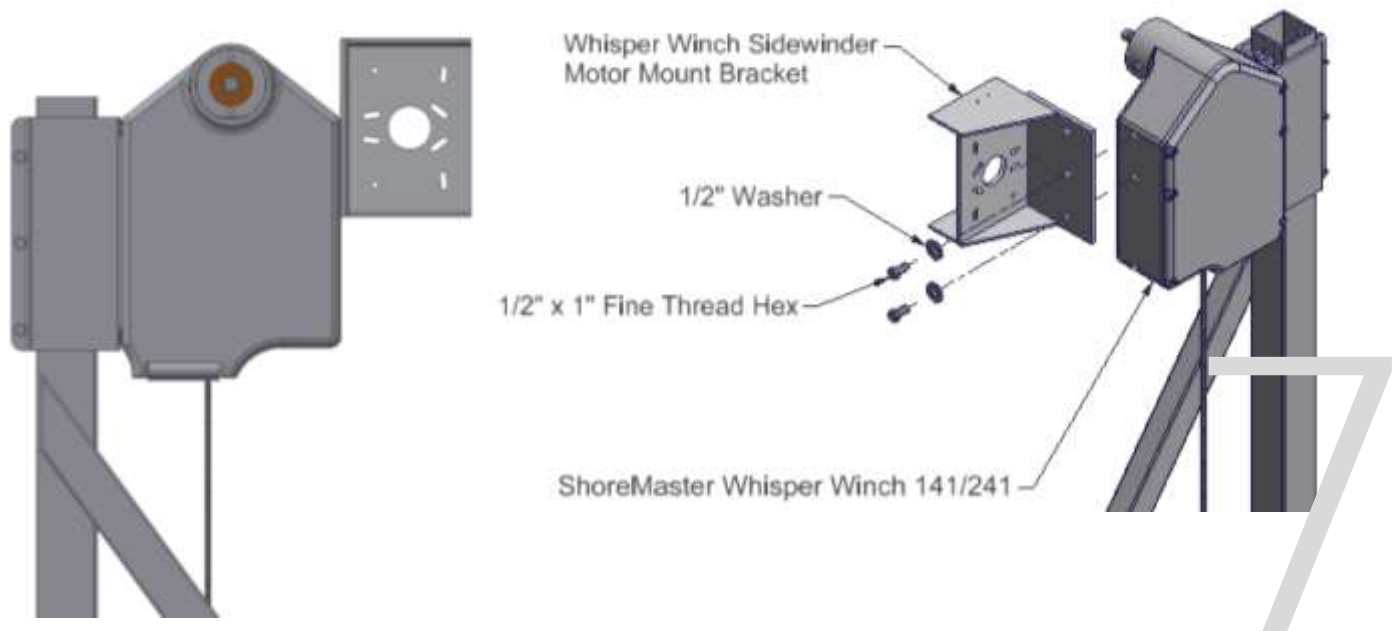

INSTALLATION continued...

Step 5: Attach motor to motor mount bracket. Make sure to position motor so the drain holes are facing downward. Attach motor using four $\frac{1}{4}$ " x $\frac{3}{4}$ " hex flange bolts (leave bolts loose).

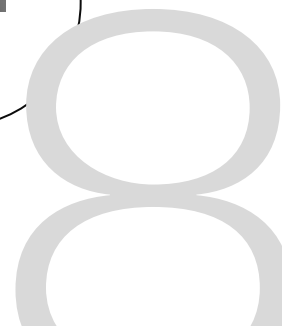

INSTALLATION continued...

Step 6: Attach the 10-tooth gear to shaft on motor, sliding gear onto shaft with square-shaped gear key; gear key fits into both the slot in the motor shaft and the slot in the 10-tooth gear. Secure the 10-tooth gear to shaft by tightening the (2) set screws in the 10-tooth gear with an 1/8" Allen wrench.

NOTE: MAKE SURE THE 10-TOOTH GEAR AND LARGE GEAR ARE FLUSH BEFORE TIGHTENING SET SCREWS.

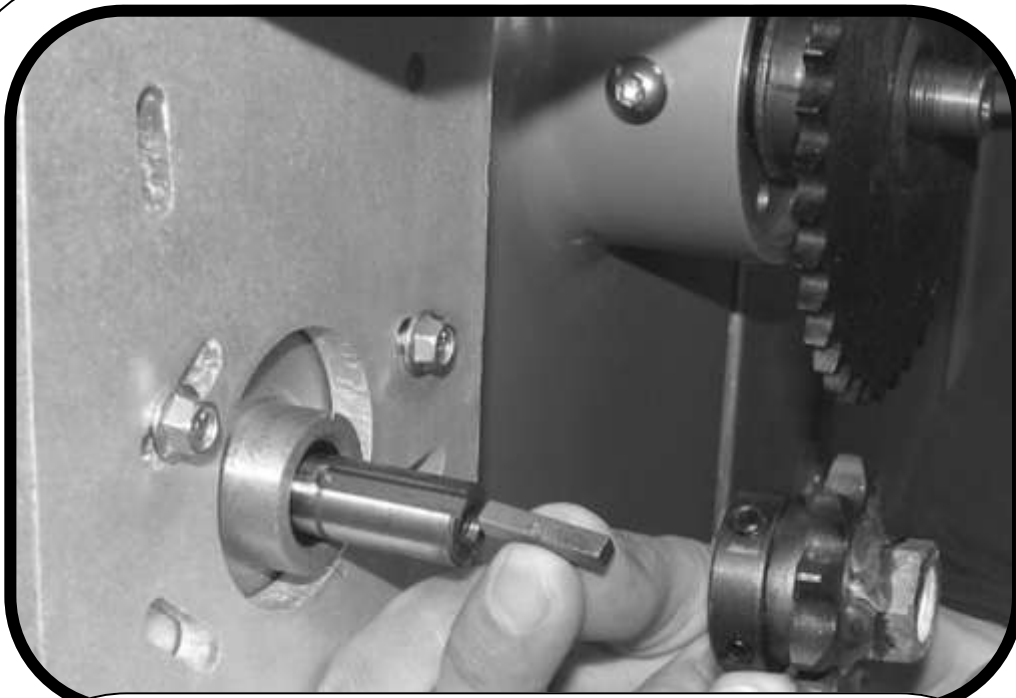

INSTALLATION continued...

Step 7: Thread large gear onto shaft on winch. Make sure the bronze washer is still on the winch shaft.

Step 8: Make sure the faces of both the 10-tooth gear and the large gear line up so they are aligned with each other. If they are not aligned use the bronze washer (7/8" x 2-1/8") to space the large gear until the faces of the gears are aligned. **DO NOT** remove any of the bronze washers.

Step 9: Install wheel kit onto winch. Your type of winch will determine the type of wheel kit you need to install.

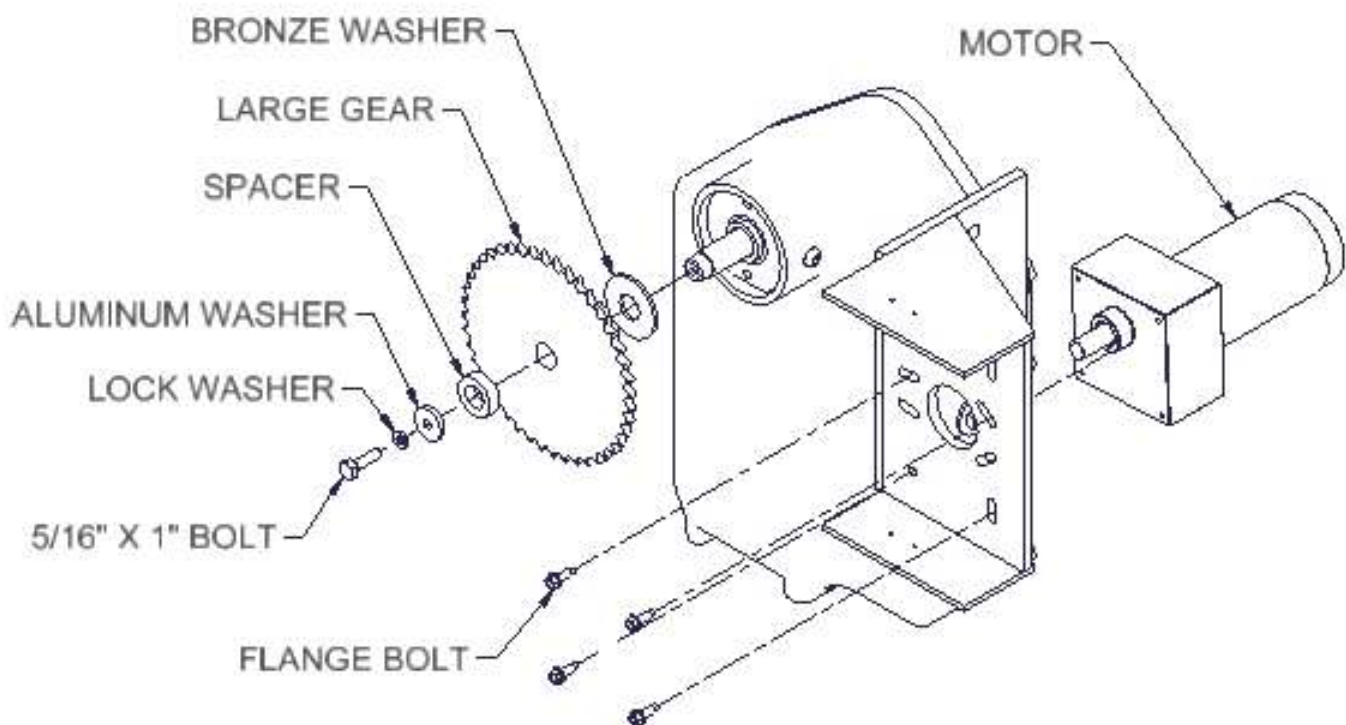

ShoreMaster® Whisper Winch™ – Make sure the bronze brake pad washer is still on winch shaft, then thread large gear onto winch shaft, place Alum spacer on winch shaft, and secure with Alum washer, lock washer and 5/16" x 1" hex bolt. Make sure there is a gap between the aluminum washer and aluminum spacer.

10

INSTALLATION continued...

The main concern with the wheel kit is to **make sure there is about a 5/32" gap between the large gear and the washer of the wheel kit** (as shown below) with the wheel kit installed. This allows the large gear to work properly with the brake pad and prevents the winch from locking up. **Do not** tighten wheel kit washer tight against gear, there **must be a small gap** between the gear and the washer for the braking mechanism to work.

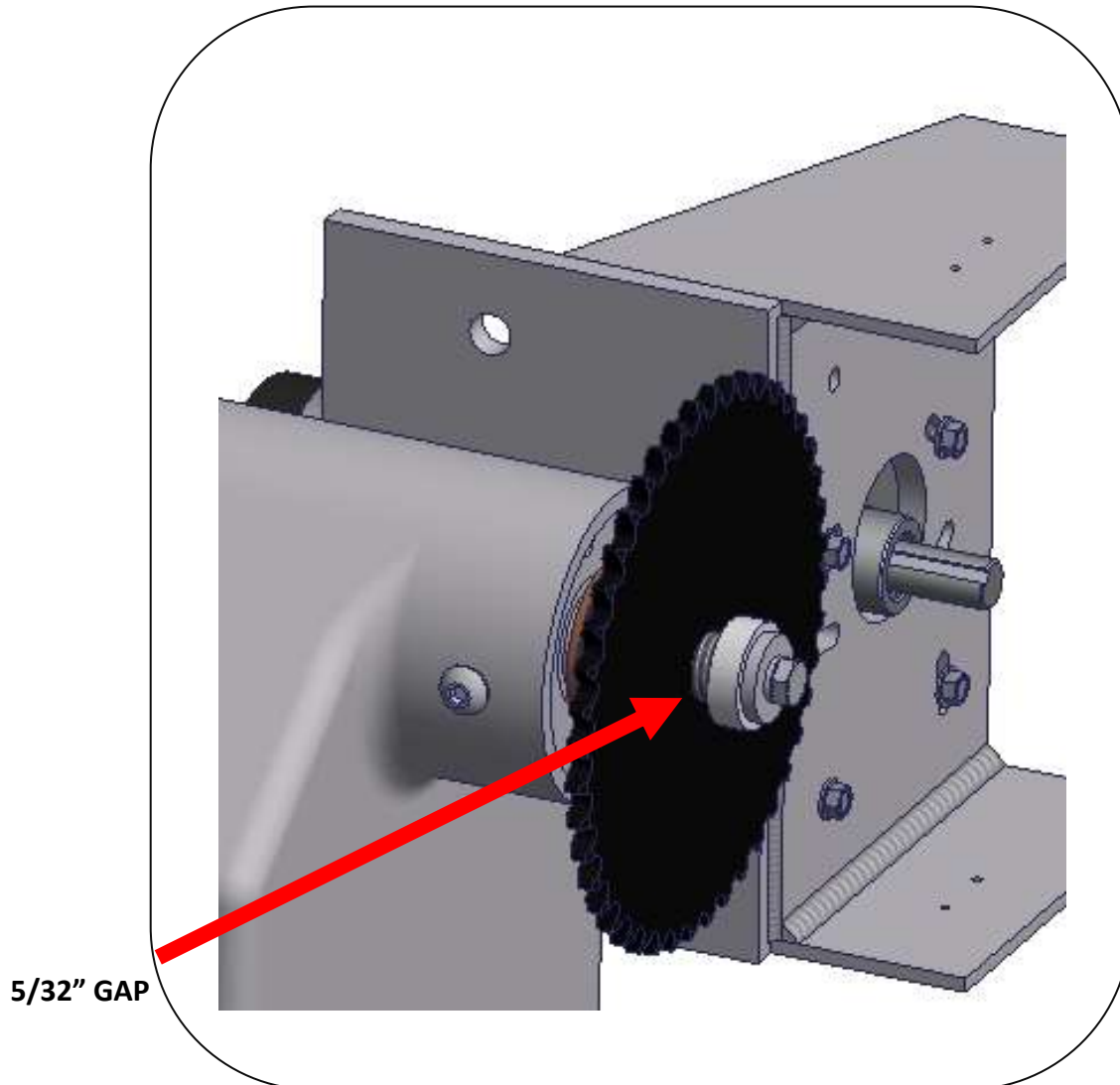

WARNING

THERE **NEEDS** TO BE A SMALL GAP OF ABOUT 5/32" BETWEEN THE GEAR AND THE WASHER. OTHERWISE, THE BRAKING MECHANISM WILL NOT WORK PROPERLY AND **COULD CAUSE SERIOUS INJURY OR DEATH.**



Sidewinder Wheel Kit Instructions

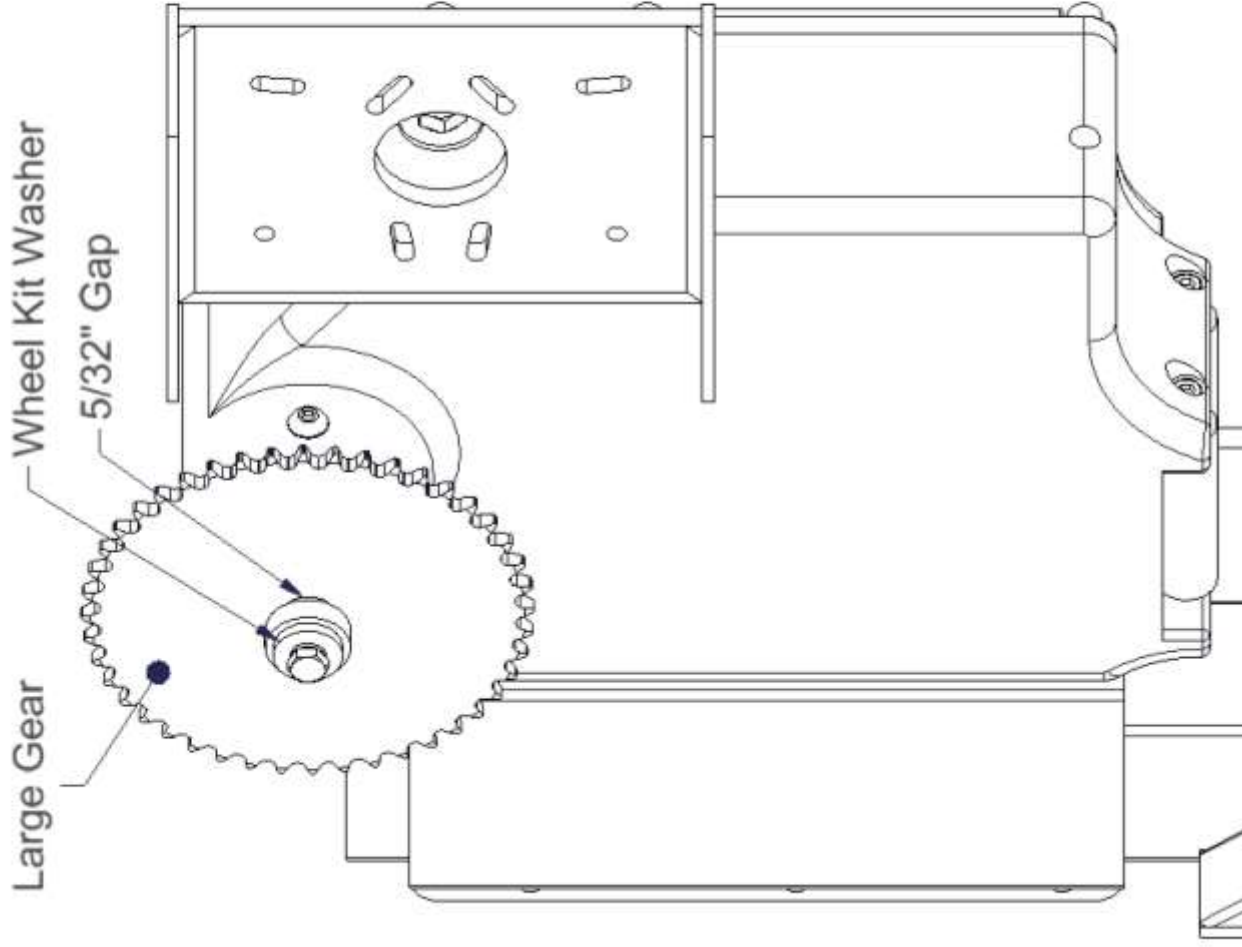

WARNING

THERE NEEDS TO BE A SMALL GAP OF ABOUT 5/32" BETWEEN THE LARGE GEAR AND THE WHEEL KIT WASHER. OTHERWISE, THE BRAKING MECHANISM WILL NOT WORK PROPERLY AND COULD CAUSE SERIOUS INJURY OR DEATH.

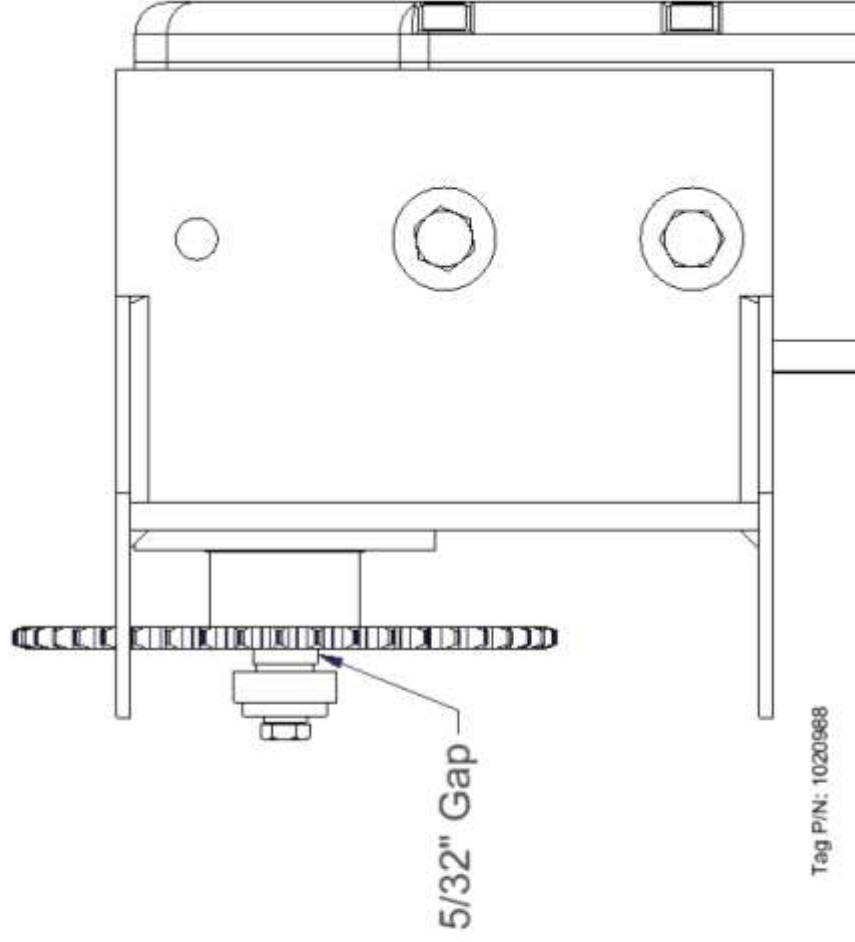

Tag P/N: 1020968

INSTALLATION continued...

Step 10: Install chain onto large and small 10-tooth gears. The gears must be in alignment for the Sidewinder™ to work properly. Wrap chain around small gear and around large gear. If chain is too short you can rotate the motor a little bit. Use the master link to attach the two ends of the chain together (as shown below).

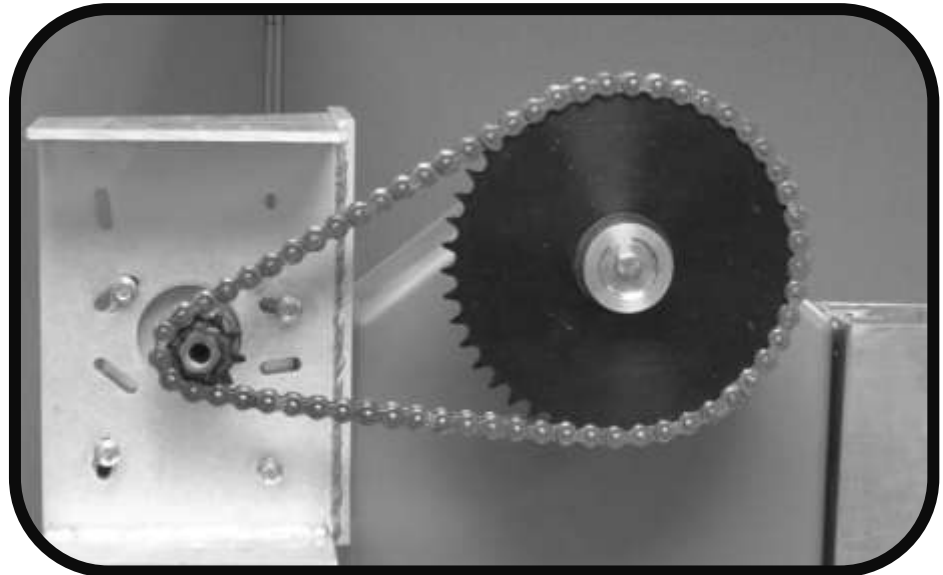

Master Link

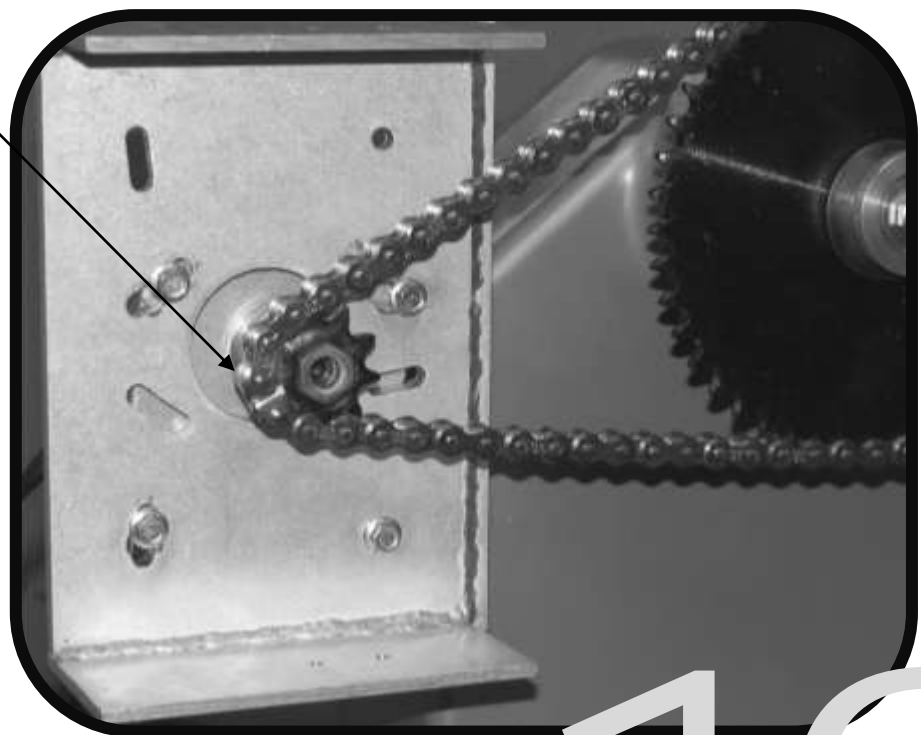

INSTALLATION continued...

Step 11: Secure motor to motor mount bracket by pivoting motor away from winch to tighten chain and tighten bolts. DO NOT over tighten.

Step 12: Slide Sidewinder™ cover onto motor mount bracket. Line up slots on top and bottom of cover with holes in the top and bottom of the motor mount bracket. Secure cover to motor mount bracket using 1/4 x 1" self-tapping screws (4 places).

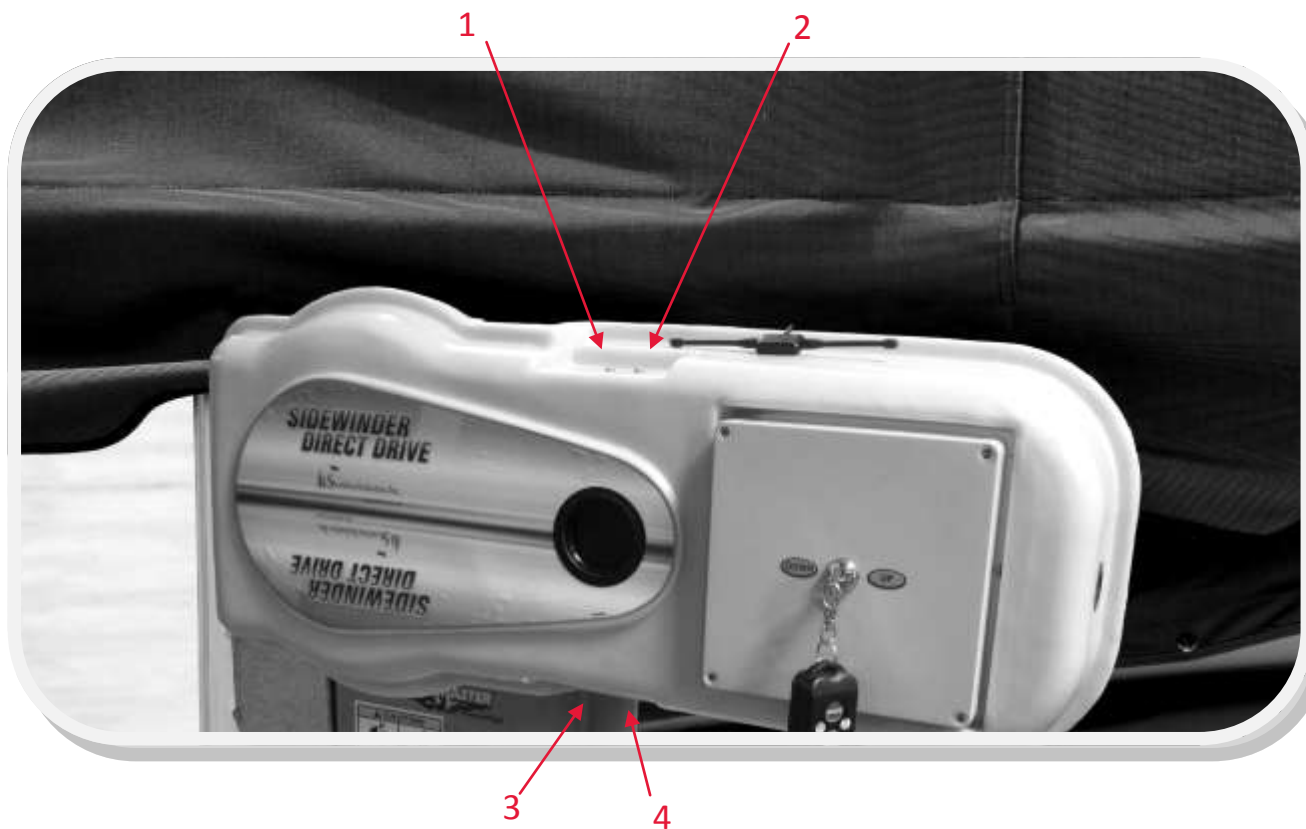

12

INSTALLATION continued...

Part # 1021707 Sidewinder Back Cover Kit - Whisper Winch Instructions



Note: If you have a sidewinder on a whisper winch you can add the back cover to your existing winch.

Use the back cover as a template and drill four 1/4" holes to attach it.

Step 1: Prior to sidewinder installation you can set the sidewinder back cover on the whisper winch wheel shaft or it can be slid on after installation.

Step 2: Install sidewinder to whisper winch if you have not already done so.

Step 3: Slide sidewinder back cover behind the sidewinder cover and over the shaft on the whisper winch.

Step 4: Secure sidewinder back cover to sidewinder cover using 4 plastic push pins by inserting them through the holes in the sidewinder back cover and pushing them into holes in the sidewinder cover (as shown).

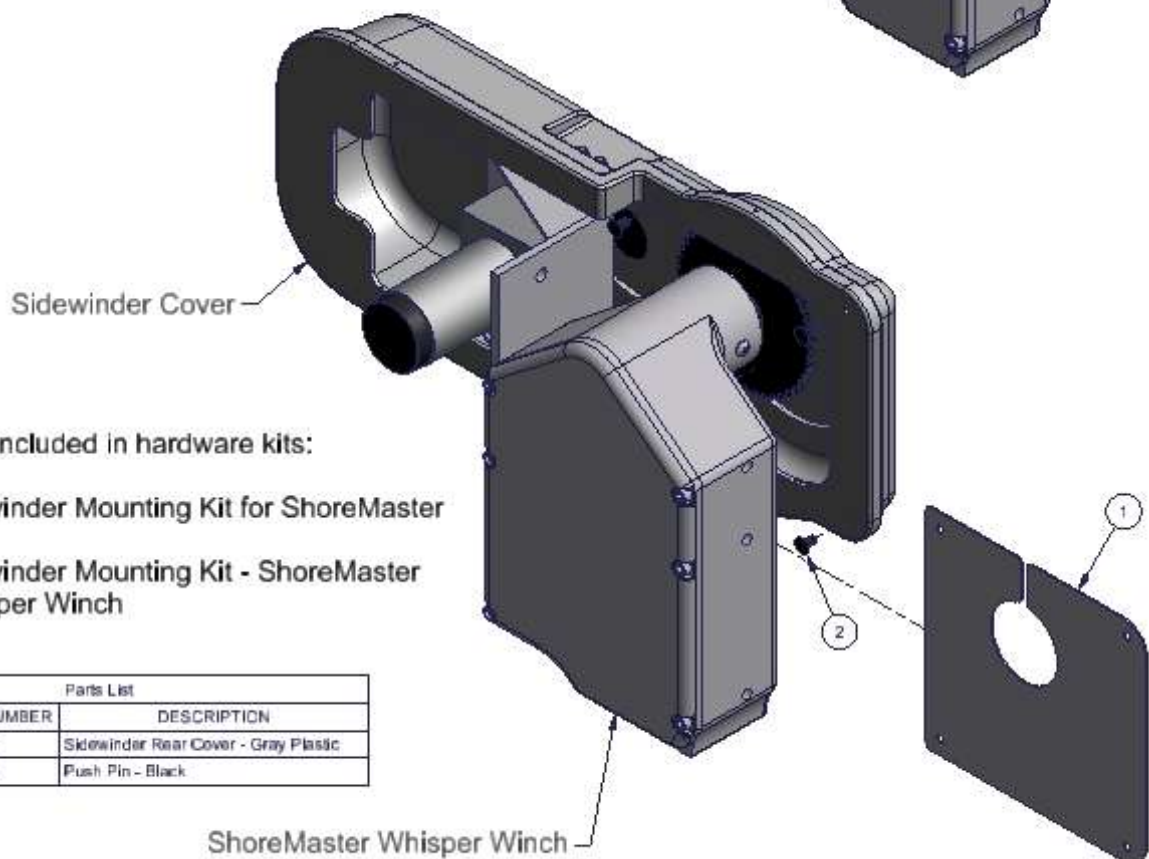
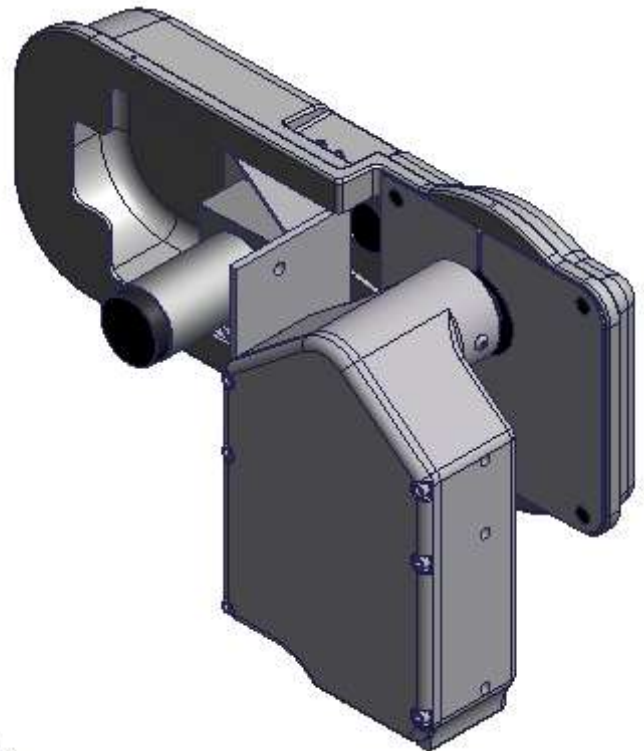

Note: This kit is included in hardware kits:

1017675 - Sidewinder Mounting Kit for ShoreMaster

1024871 - Sidewinder Mounting Kit - ShoreMaster
Whisper Winch

Parts List			
ITEM	QTY	PART NUMBER	DESCRIPTION
1	1	1021706	Sidewinder Rear Cover - Gray Plastic
2	4	1021705	Push Pin - Black

INSTALLATION continued...

Step 13: Plug power cord from motor into power cord from control unit found in cover.



Step 14: If your Sidewinder™ came with the optional remote, attach the remote antenna to the top of the Sidewinder™ cover.

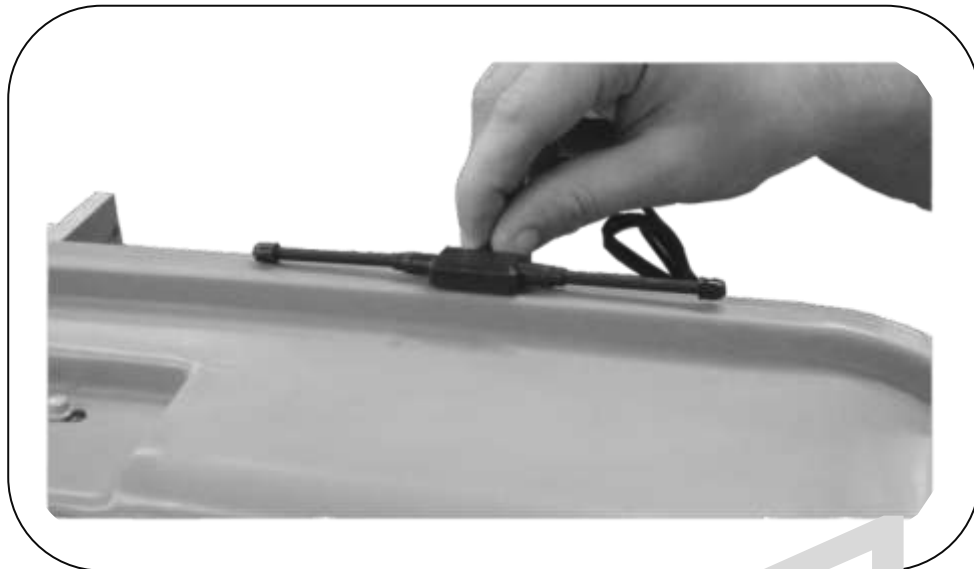

INSTALLATION continued...

Step 15: Press round black Caplug[®] cap into hole in cover. The hole is used for manually operating Sidewinder™ with a $\frac{3}{4}$ " **socket**. You can use either a socket wrench or a drill with a socket adapter to manually operate the Sidewinder™.

NOTE: Caplug[®] cap may have been installed at factory.



To manually operate Sidewinder™, remove black Caplug[®] cap in center of Sidewinder™ cover and use a $\frac{3}{4}$ " **socket** to raise or lower your lift by turning the nut that is on the 10-tooth gear clockwise or counterclockwise, respectively (as shown below).



WARNING

BEFORE SERVICING SIDEWINDER UNIT,
DISCONNECT POWER.



$\frac{3}{4}$ " Socket

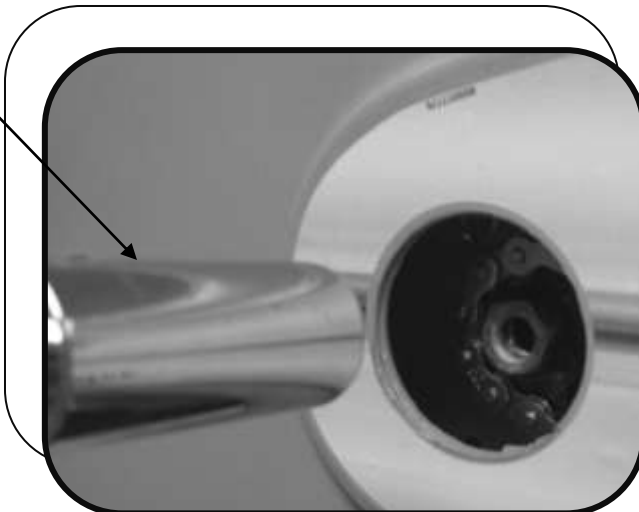

15

INSTALLATION continued...

Step 16: Connect power cord to power supply. For 110 volt Sidewinder™ make sure power supply has only one GFCI. Consult an electrician if you are not sure. For 12 volt Sidewinder™ **make sure to connect the red power cord to the positive terminal and the black cord to the negative terminal of your battery.**

Note: Use a group 27-deep cycle battery for 12 volt Sidewinders™.

Step 17: Use cable ties to secure loose cables (cable ties included).

Step 18: Attach up / down stickers to cover by toggle or key switch by removing tape backing and applying sticker to cover. The up sticker should be placed above the toggle switch or to the right of the key switch and the down sticker should be placed below the toggle switch or to the left of the key switch (see below).



Step 19: Attach light to desired location and plug into Sidewinder™.

Note: If you use a light other than the one supplied use a light bulb with a maximum of 50 watts.



Step 20: Test operation of Sidewinder™. Press the up button on the remote or use the key or toggle switch to activate the Sidewinder™ to raise your boat lift. Watch to make sure the lift is rising. Check that the cable on the winch is spooling onto the winch in the correct direction and it is not spooling onto the winch backwards. Press the down button on the remote or use the key or toggle switch to activate the Sidewinder™ to lower your boat lift. Once you have verified the Sidewinder™ is operating properly you can start to use your lift.

Shoreline
Industries Inc.

INDUSTRIES

*Remote
Instructions*

THE
BEST
OF
THE
BEST

SIDEWINDER



1025 International Drive • Fergus Falls, MN 56538 • 218-587-8700
www.shoreline-ind.com

REMOTE CONTROL

Your system is equipped with an electronic remote control receiver box and two hand-held remote controls (key fobs). The two remotes and receiver box are uniquely programmed to operate as a system. As a result of this unique programming, your two remotes are the only units that can communicate with your receiver. This feature provides you the security that only the person possessing the remotes can operate your boatlift remotely.

NOTICE: Do not operate the Sidewinder™ with the remote and manual switch at the same time.

Remote Control Maintenance: When the **batteries expire you will need to replace them with two CR 2025 (3V)**. The remote is watertight but is **not** intended to be submerged. If the remote does get submerged the best thing to do is to replace it.



CAUTION: If you try to use the remote control after it has been submerged the remote can short out and cause the Sidewinder™ to unexpectedly operate.

It is **possible for the transmitter to de-program either due to loss of power (dead battery) or electrical interference**. First check to see that it is transmitting. Do this by depressing any button and watching to see that the transmitter LED lights up. If not, change the two CR 2025 (3V) batteries in the transmitter and try again. If the LED lights up but the remote control will not operate the lift, you may need to reprogram the transmitter.

Remote Operation (SEE GUIDE BELOW)

Note: The lift can still be operated with the key switch even if the remote fob is locked.

NOTICE: Allow motor to stop before reversing directions.

Please note that the two Lithium CR2025 (3V) batteries **are not available through Shoreline, they will need to be purchased elsewhere.**



Remote Guide

Press the  to move the lift up.

Press the  to move the lift down.

Press the  to turn the canopy light on.

Press the  and  to lock and unlock your lift.



REMOTE CONTROL REPROGRAMMING INSTRUCTIONS

To reprogram remotes follow below instructions.

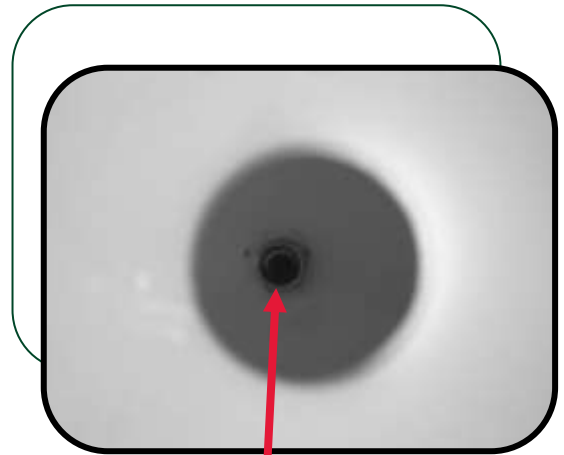

A **Closer view of red button once plug has been removed**

Remove plug to proceed to steps 1 & 2.

Step 1 - Remove black plug on end, be sure to cover hole when you are done. Hold down the Red Button (A) inside the gray sidewinder cover for 3 to 5 seconds.

Step 2 - Press the "UP"  Button on the Remote Key Fob until the red light appears. Repeat these steps for the second Remote Key Fob. Note: Only two Key Fobs can be programmed at a time.

- Verify the battery or power to unit is connected properly.
- Reprogram the remote fobs per instructions above. Verify that both remote fobs work.



Please note that the two Lithium CR2025 (3V) batteries **are not available through Shoreline, they will need to be purchased elsewhere.**

Place one battery on top of the other as pictured left and insert into remote.

TROUBLE SHOOTING

FAQ: THE MOTOR DOESN'T RUN

A: Check the battery charge, recharge if necessary.

A: Check the battery connections, clean and re-secure if necessary.

A: Check the fuses and replace if required.

FAQ: THE BATTERY WILL NOT HOLD A CHARGE

A: Verify that the loaded boat is not exceeding the weight capacity of the lift.

A: Ensure the solar panel is properly connected.

A: Re-align the solar panel for proper exposure to the sun.

A: Recharge the battery with a 10 amp charger and check charge.

A: Have the battery tested. It may be old or bad and require replacement.

A: If the lift is being used frequently during the day, it may be necessary to use a 110-volt trickle charger.

FAQ: THE REMOTE CONTROL IS NOT FUNCTIONING

A: Verify that the LED on each remote control key fob comes on when each button is pushed. If the LED does not work or is dim, replace the key fob batteries.

A: Check the fuses and replace if required.

A: Make sure antenna wire on the unit's remote receiver is located properly.

A: Reprogram the remote key fobs. Refer to Remote Instructions

A: Press the circuit breaker re-set button found behind plug on end of sidewinder cover.

A: Reset GFCI, on 110 volt models.

FAQ: SIDEWINDER MAKES GRINDING NOISE DURING OPERATION

A: Gears on sidewinder and winch may not be in alignment, refer to instructions to align gears.